



Project:

Item:

Quantity:

DIRECT THERMAL PRINTER - SPEC SHEET

DIRECT THERMAL PRINTER



FEATURES

- Direct thermal monochrome print method
- ZPL and EPL programming languages
- 5 status icon, 3 button user interface
- USB 2.0, USB Host
- Bluetooth low energy
- OpenACCESS™ for easy media loading
- Dual-wall frame construction
- ENERGY STAR qualified
- Including label dispenser, 1 roll of 2 x 2.25" labels, cables and fully configured

PRINTER SPECIFICATIONS

- Resolution 203 dpi/8 dots per mm
- Memory: 512 MB Flash; 256 MB SDRAM
- Maximum print width: 2.2"/56 mm for 203 dpi
- Maximum print speed: 6"/152 mm per second (203 dpi)
- Firmware: ZPL II, EPL 2, EPL Line Mode, XML, ZBI

DESCRIPTION

This ultra-compact printer creates high-quality labels. Easy to use and operate, especially fit for food service purposes.



WARRANTY

Henkelman Inc offers a warranty of 1 year on labor and parts, standard on Printer only. For full warranty details, please refer to www.henkelman.com.

DATE

APPROVAL



FIT FOR FOOD SERVICE
WWW.HENKELMAN.COM

HENKELMAN INC.
493 W Fullerton Ave
Elmhurst IL, 60126

Sales and technical support
P +1 331 979 2013
F +1 630 359 3875
E info@henkelmanusa.com
Service and warranty
P +1 844 208 5685

HENKELMAN INC

DIRECT THERMAL PRINTER – SPECS

DIRECT THERMAL PRINTER – SPEC SHEET

DIMENSIONS

In inches

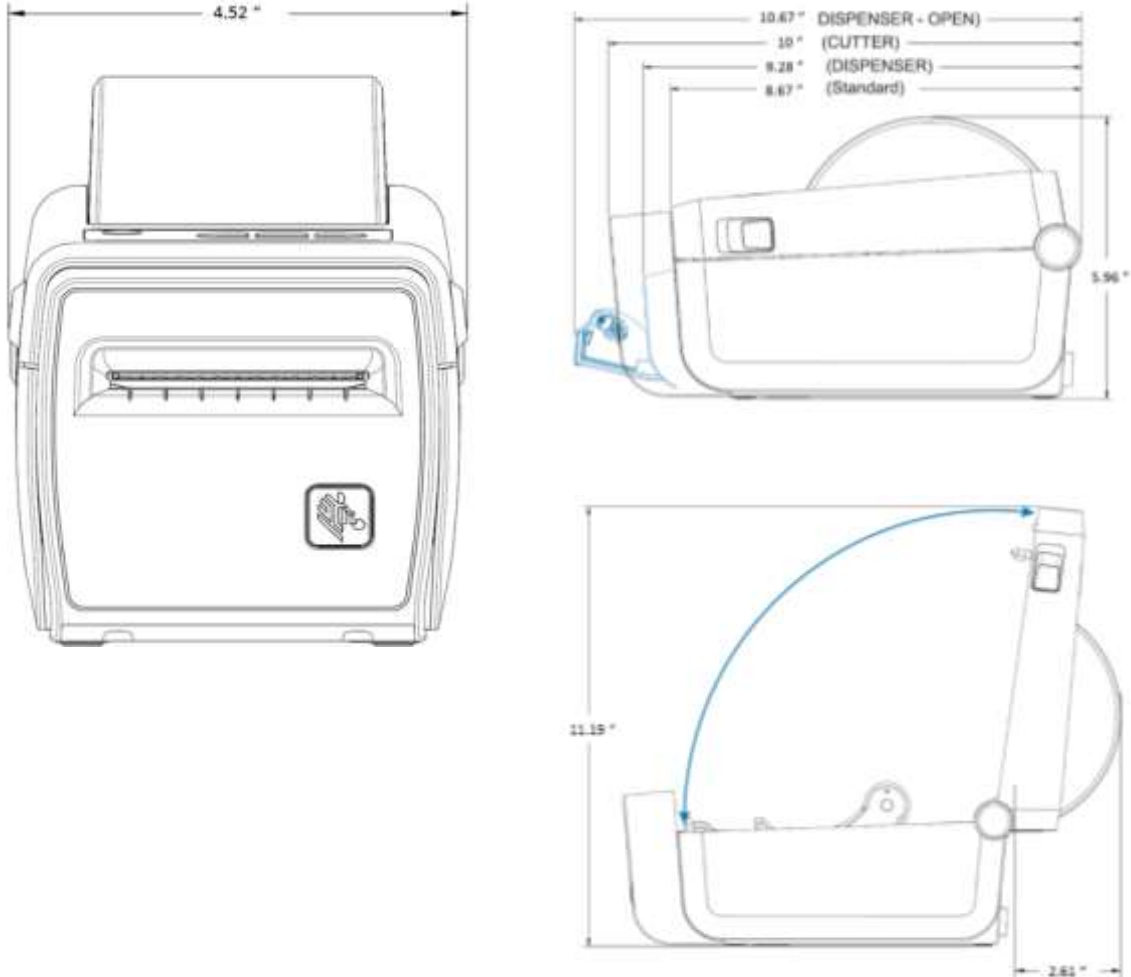

Model	Dimensions (Inches)	Hz	Electrical	Weight (lbs)
Zebra ZD410	L x W x H 8.6" x 4.5" x 6.0"	50-60 Hz	Auto-detectable (PFC Compliant) 90-265VAC ENERGY STAR qualified	2.2 lbs



FIT FOR FOOD SERVICE
WWW.HENKELMAN.COM

HENKELMAN INC.
493 W Fullerton Ave
Elmhurst IL, 60126

Sales and technical support
P +1 331 979 2013
F +1 630 359 3875
E info@henkelmanusa.com
Service and warranty
P +1 844 208 5685

HENKELMAN INC